

427000889

Keep this manual so that it is always available for future use.

ENG Drying Cabinet Service Manual

Article and serial number

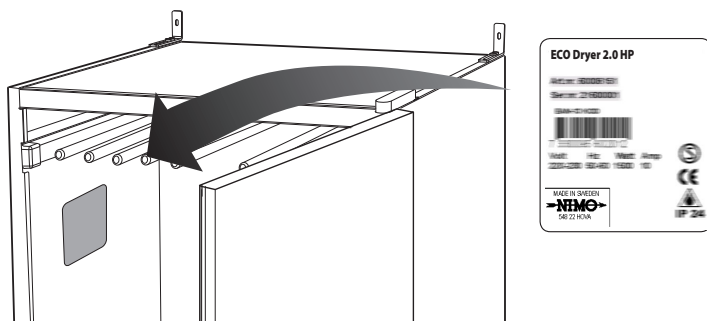

This service manual

The contents of this service manual describe the **programming function** of the dryer, such as **activation/deactivation of programming mode** and **parameter adjustment**.

The manual also contains instructions for **rehanging the door** and **disassembling the dehumidifier unit**.

For a description of the drying cabinet, see the **Installation and User Manual**.

Manufacturer:

NIMO-VERKEN AB
Box 124
S-548 22 HOVA
Tel +46 (0)506 / 488 00
Fax +46 (0)506 / 488 10
nimo@nimoverken.com
www.nimoverken.com



Doc. No: 427000889 Rev. 04

Right to make changes reserved.

Printed on environmentally friendly paper meeting the requirements of Friends of the Earth Sweden and the Swedish Society for Nature Conservation.

Contents

1	<i>The drying cabinet</i>	4
2	<i>Wiring diagram</i>	5
3	<i>Replacement of display</i>	6
4	<i>Rehanging the door</i>	7
5	<i>Dehumidifier unit – disassembly</i>	10
6	<i>Programming</i>	12
	6.1 <i>Control panel</i>	12
7	<i>Drying programmes</i>	13
	7.1 <i>Selection of drying programme</i>	13
8	<i>Drying function</i>	14
	8.1 <i>Start the drying programme</i>	14
	8.2 <i>Stop the drying programme</i>	15
	8.3 <i>The door is opened</i>	15
9	<i>Setting of drying programme</i>	16
	9.1 <i>Introduction</i>	16
	9.2 <i>Procedure</i>	17
	9.3 <i>Resetting to factory setting</i>	17
10	<i>Trouble-shooting</i>	18
11	<i>Error code list</i>	23

1 The drying cabinet

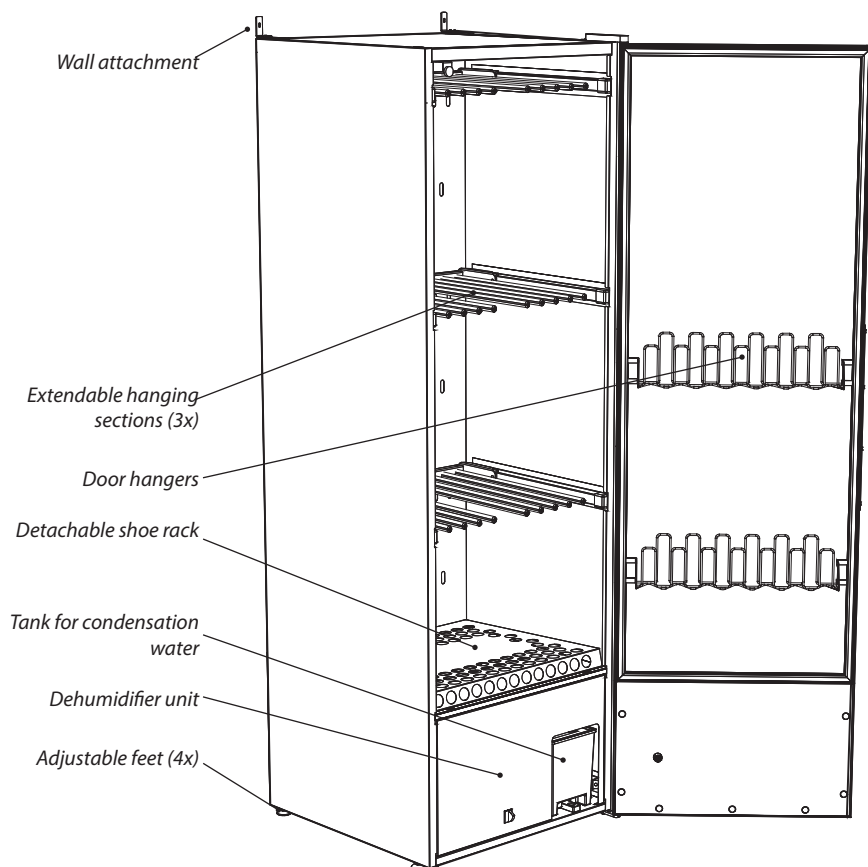

2 Wiring diagram

Wiring diagram 106159-0

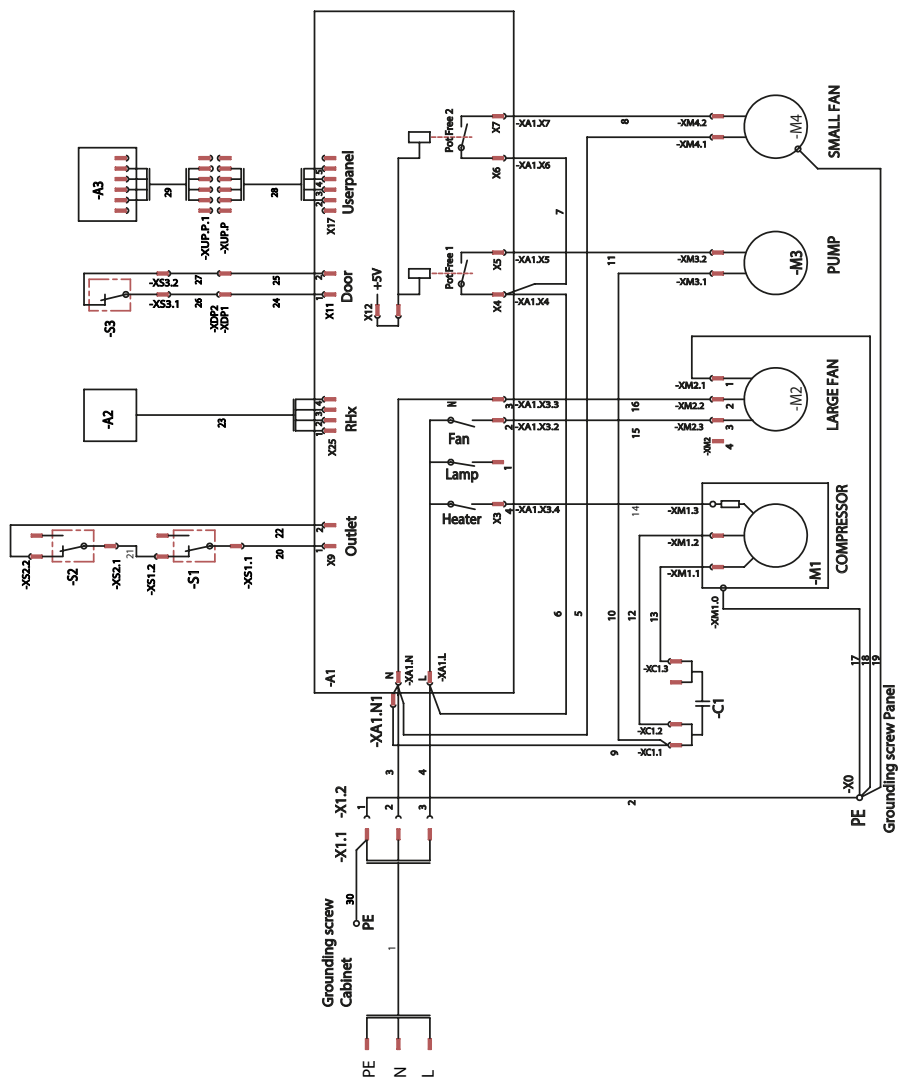

3 *Replacement of display*

- 1 Open the door and detach four screws (1) holding the display (2).

If the glove hanger is covering the screws, detach the hanger temporarily.

Detach the display from the door. Take care to avoid damaging the cable.

- 2 Detach the cable from the display and remove the old display.
- 3 Connect the cable to the new display and press the display home in the door.
- 4 Attach the new display to the door with the screws.

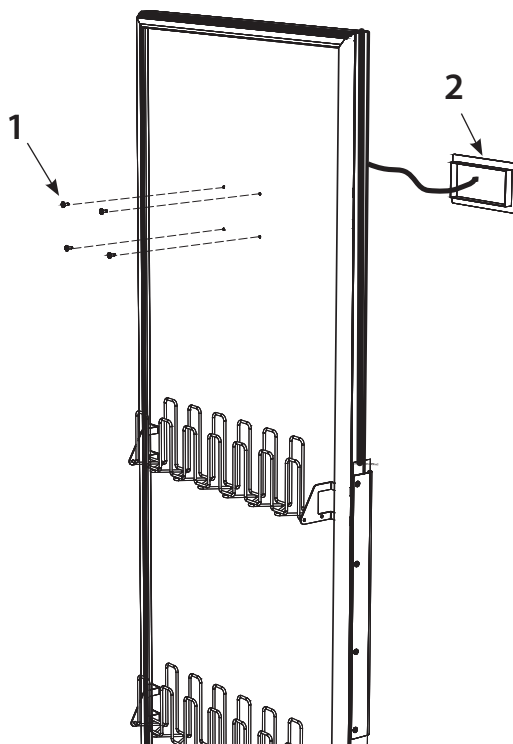

4 Rehanging the door

The cabinet is supplied from the factory with a right-hung or left-hung door. The door can be rehung afterwards.

A rehanging kit is needed to rehang the door. This can be ordered as a spare part.

Rehanging kit

- Upper hinges, 1 right and 1 left

The description below shows rehanging from right-hung door to left-hung.

- 1 Open the door and detach four screws (1) holding the display (2).

If the glove hanger is covering the screws, detach the hanger temporarily.

Detach the display from the door. Take care to avoid damaging the cable.

- 2 Detach the cable from the display and remove the display. Let the cable hang down.

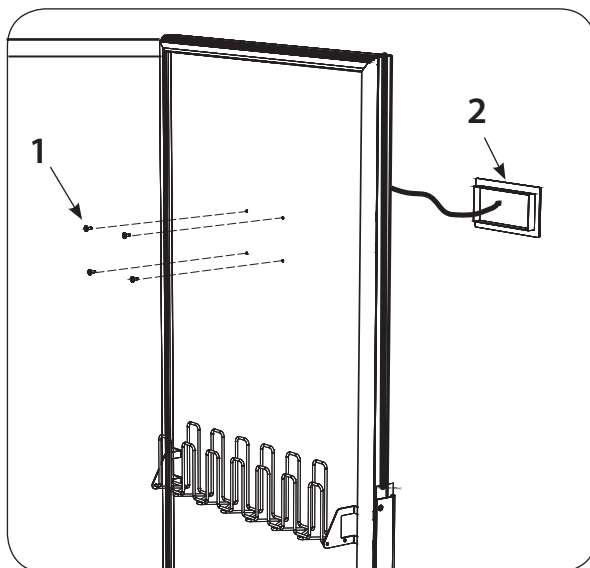

- 3 Detach the cabinet from the wall and rotate to gain access to the rear.

- 4 Detach the two screws holding the top panel. You will find the screws under the blanking plugs (3), as illustrated, and disassemble the panel.

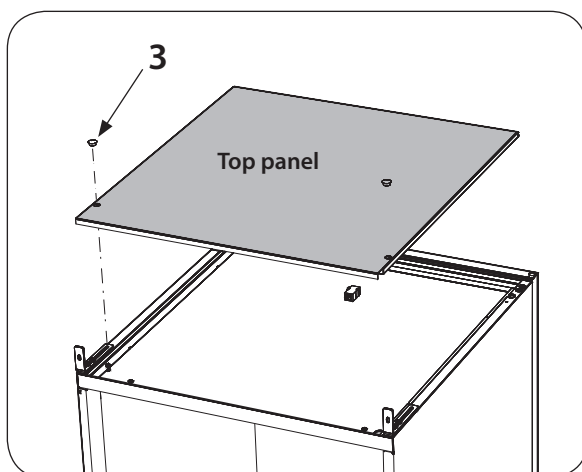

5 Carefully lay the cabinet on its back.

6 Remove the protective cover **(4)** of the upper hinge **(5)** and release the door cable **(6)**. Disassemble the hinge which is attached by two screws. Carefully pull the hinge away from the cable.

Discard the hinge.

The hinge features a slot where the cable is threaded in or out.

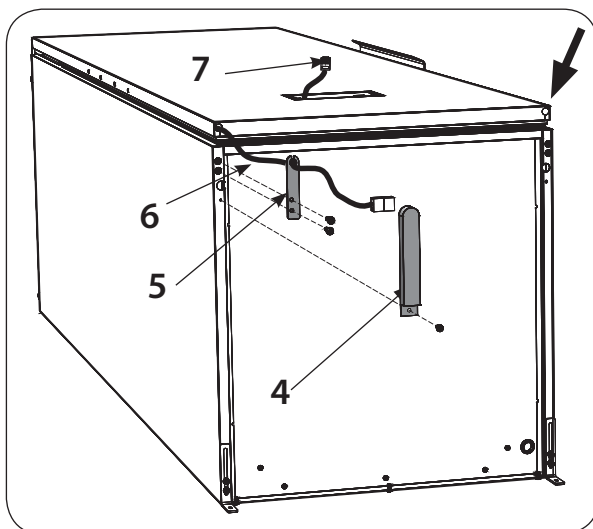

7 Carefully pull the door cable out together with the plastic bushing. If the connector **(7)** is taped, it is easier to pull the cable out.

8 Take out the new upper hinge from the rehanging kit and thread the new cable onto this in the same way that the old one was detached from the cable.

9 Thread the cable into the door at the arrow shown in the illustration and press the plastic bushing home. Fit the hinge and the hinge cover.

10 Refit the top panel of the drying cabinet which was removed under point 4.

11 Locate the cable so that it reaches the opening of the display.

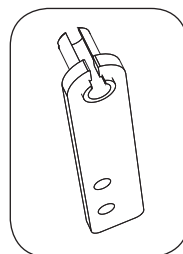

*Upper door hinge
(right-hung door)*

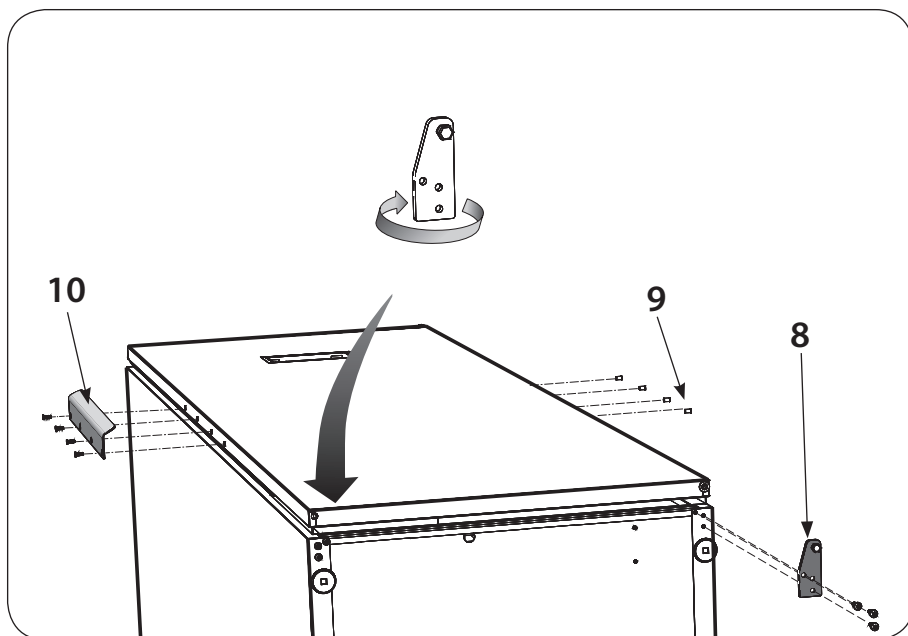

- 12** Move the lower hinge (**8**) to the other side. The hinge must be inverted and the hinge pin unscrewed and refitted on the other side of the hinge.

Make sure that you tighten the hinge pin properly.

- 13** Detach the blanking plugs (**9**) and the door handle (**10**). Change sides for the parts.
- 14** Raise the cabinet to the upright position.
- 15** Locate the door cable connector and refit this in the display. Position the display and secure this with the four screws from the inside of the door.
- 16** Position the cabinet and **secure the cabinet to the wall.**

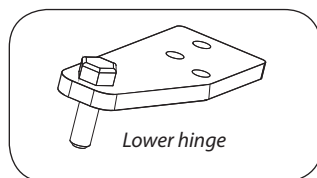

5 Dehumidifier unit – disassembly

The dehumidification unit consists of an enclosed unit in the lower part of the cabinet.

The whole unit has to be pulled out for servicing.

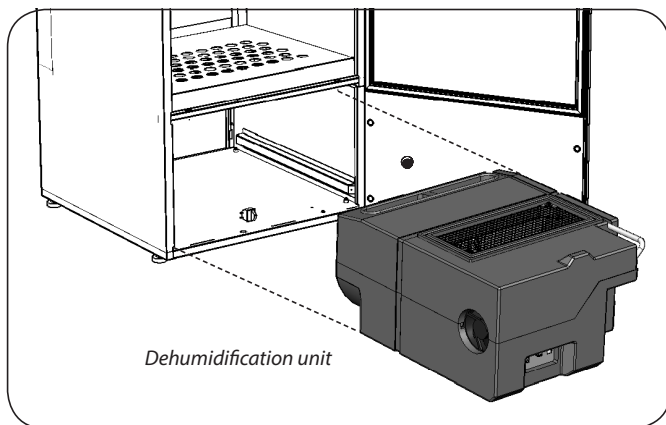

From the rear

- 1 Detach the cabinet from the wall and turn it to gain access to the rear.
- 2 Unscrew 3x screws (1). The screws have Torx T40 heads.

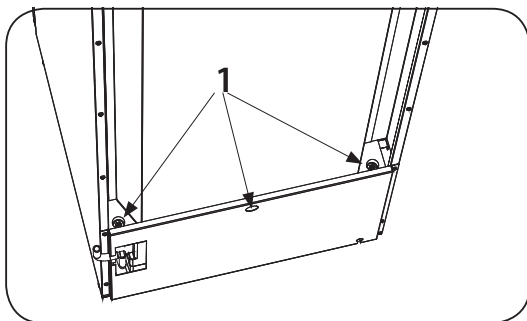

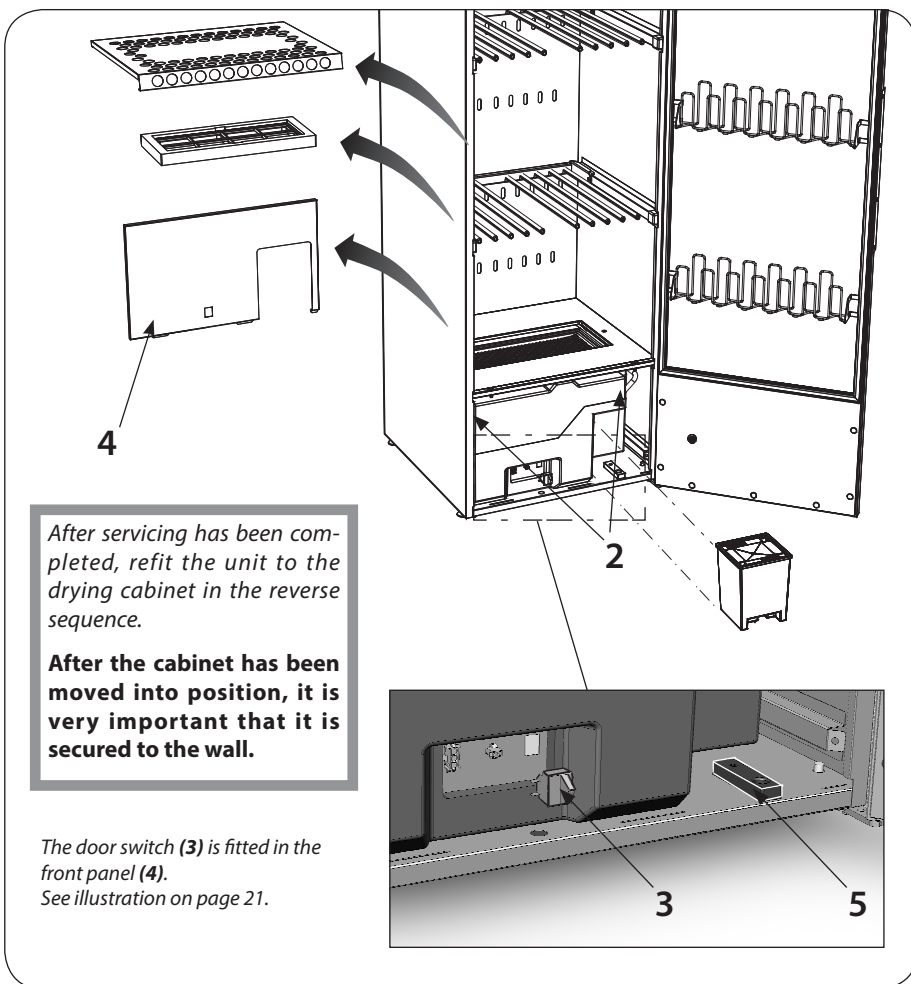

From the front

- 3 Remove the shoe rack and disconnect the filter holder.
- 4 Remove the cover plugs and detach the front panel which is attached with 2x screws (2) (Torx T20). Disconnect the door switch cable (3).
- 5 Detach the mains lead and the communication cable.
- 6 Remove the water container.
- 7 Unscrew the guide (5) for the water tank. One screw holds the guide in place.
- 8 Pull out the dehumidifier unit.

6 Programming

6.1 Control panel

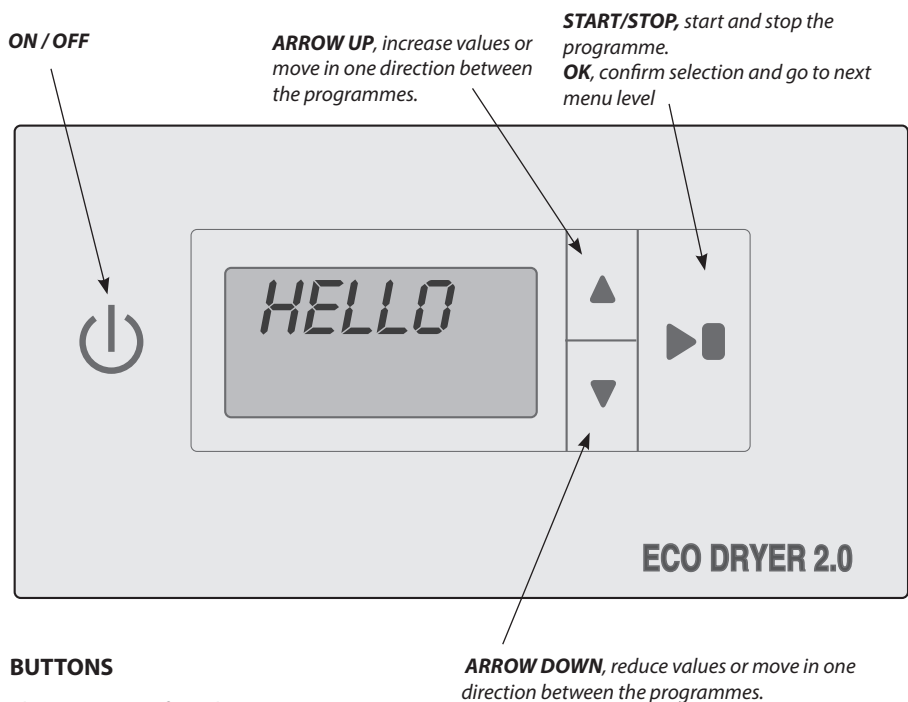

7 ***Drying programmes***

Chapters 7, 8 and 9 also appear in the User Manual

The drying cabinet is equipped with two automatic programmes:

- ☐ NORMAL DRY
- ☐ EXTRA DRY

The automatic programmes switch the drying process off automatically when the items of clothing are dry.

7.1 Selection of drying programme

- ☐ NORMAL DRY– Used for drying of garments of normal thickness
- ☐ EXTRA DRY – Used for drying of thicker garments, deep drying

8 *Drying function*

8.1 *Start the drying programme*

□ *Last used drying programme*

Press the ON/OFF switch to the **"ON"** position, indicated by the display lighting up and showing the last run programme.

After a few seconds the display will show the last run programme. If this is the programme you want, press **START/STOP**.

Or choose another drying programme by stepping up or down.

Then start the drying programme with the **START/STOP** button.

□ *Door open*

If the door is open when the drying programme is started and the **START/STOP** button is activated, the display shows **"CLOSE DOOR"**.

Close the door and the selected drying programme will start.

□ *In operation*

The **animated symbol** (bar) on the left-hand side of the display indicates that the drying process is in progress.

□ *Condensation water tank*

If the condensation water tank becomes full, the drying process is immediately discontinued and the display will show **"CHECK WATER TANK"**. Empty the water tank and re-start the drying process.

□ *Cooling*

During the cooling period the display shows the text **"COOL"** and counts down 5 min, remaining time.

□ *Programme end*

When the cooling period has ended, the drying process is finished, and the display shows the text **"END"** (flashing).

When the **START/STOP** button is pressed or the door is opened, the current programme is stopped and the display shows the most recently used programme.

8.2 *Stop the drying programme*

To discontinue a drying process in progress, press **START/STOP**.

8.3 *The door is opened*

If the door is opened when the drying process is under way, the drying process will continue for a further 5 minutes. The display will show "*CLOSE DOOR*" and a programme pause period of 5 minutes will be counted down.

If the door is closed within this 5 minute period, the drying process continues.

If the door is left open, the drying process is discontinued after 5 minutes and has to be re-started manually.

If you wish to discontinue the drying process immediately, without a 5 minute period, press **START/STOP**.

9 *Setting of drying programme*

There are options for optimizing the drying cabinet's two automatic programmes for best results.

This is done by adjusting parameter values for the automatic programme concerned on the control panel.

Values are displayed as follows:

The current parameter is shown on the top line of the display, e.g. "P 2071", the set value of the parameter is shown on the bottom line.

Changes should only be made if you find that:

- ☐ the washing is not dried sufficiently
- ☐ the washing is over-dried – long drying time.

9.1 *Introduction*

The drying cabinet is equipped with two drying programmes, **Normal dry** and **Extra dry**.

Normal dry programme *is controlled through moisture sensor.*

Extra dry programme *is controlled through moisture sensor and a time factor.*

The automatic programmes end automatically when the washing is dry.

To decide when the washing is dry, a measured value is compared with a factory-set parameter, parameter **P 2072** for **Normal dry** automatic programme and parameter **P 2071** for **Extra dry** automatic programme.

It is primarily these two parameters that are adjusted to optimise the drying process.

- ☐ If you find that washing is not dried sufficiently in:
 - Normal dry** automatic programme *reduce* the parameter value for **P 2072**.
 - Extra dry** automatic programme *increase* the parameter value for **P 2071**.
- ☐ If you find that washing is over-dried, long drying time in:
 - Normal dry** automatic programme *increase* the parameter value for **P 2072**.
 - Extra dry** automatic programme *reduce* the parameter value for **P 2071**.

Optimisation of the drying process must always take place in small steps, start by adjusting the parameter concerned by 1-2 units up or down, then check the result after the next drying process and if appropriate make a further adjustment.

9.2 Procedure

- 1 Make sure that the main **ON/OFF** switch of the drying cabinet is in the OFF position. The display is not lit.
- 2 Hold down the **UP** and **DOWN** buttons and press the main **ON/OFF** switch to the "**ON**" position. The display lights up and shows the parameter "**P105**" and the factory preset value of P105. The row containing the parameter concerned flashes on the display.
- 3 Step through to the parameter concerned by pressing the **ARROW UP** or **DOWN** button repeatedly. If you go too far, all you need to do is to continue stepping forward until the display shows the correct parameter.
- 4 When the display shows the correct parameter, e.g. "**P2072**", press **START/STOP** to confirm parameter selection. The row now flashes with the set value of the parameter.
- 5 Increase or reduce the parameter value using the **ARROW UP** or **DOWN** buttons.
- 6 To save the set value, press **START/STOP**.
- 7 To return to the operating value, press the **ARROW DOWN** and **START/STOP**.

9.3 Resetting to factory setting

- 1 Go to parameter display mode as described in 1-2 above.
- 2 Hold down the **ARROW UP** and **ARROW DOWN** buttons and press **START/STOP**. The factory buttons will be saved and the display will show the most recently run programme.

10 *Trouble-shooting*

Questions	Action
The drying cabinet does not work	<ol style="list-style-type: none">1. Check that the mains lead is connected to a socket.2. Check that no fuse has blown.3. Have you pressed the start button?4. Is the door closed?5. Is the water tank in position and empty?
<p>The display shows <i>CHECK WATER TANK</i></p> <p>See illustrations</p>	<ol style="list-style-type: none">1. Empty the water tank2. Check that the cover is fitted so that the float arm protrudes out of the opening in the lid and that the arm runs freely.3. Check that the water tank is turned so that the float arm is inside the box.4. If none of the above work, the safety switch for a defective pump may have been activated.5. Turn off the power supply.6. Take out the shoe rack.7. Take out the lint filter.8. Check whether there is water in the tray. If so:9. Check that the drain hose is not caught or bent so that a kink has developed or the hose runs at too steep an angle to the drain without forming a "trap".10. Loosen the grille over the tray which is attached with 2x Torx 40 screws.11. Loosen the panel holding the protector over the pump. Attached with 1x Torx 40 screw.12. Remove the Styrofoam protector over the pump.13. Detach the panel holding the microswitch and moisture sensor, which is attached with 1x Torx screw and take out the float.14. Mop up the water with a sponge or rag.15. Refit and check that the microswitch has a small gap from the float of 1-3 mm.16. Refit other parts.17. Connect the power supply and test-run the cabinet, the pump should start to pump immediately.18. If the problem persists, the whole unit must be replaced.

Questions	Action
<p>The display shows <i>CLOSE DOOR</i></p> <p>See illustrations</p>	<ol style="list-style-type: none"> 1. Check that the door seals tightly so that the door switch is activated. (Located at the bottom of the cabinet on the cover panel in front of the heat pump unit). 2. If necessary try to tape down the switch and check whether the warning disappears in the display. 3. If none of the above work, disconnect the power supply and disassemble the front panel (see description in Chapter 5 Dehumidifier unit disassembly). 4. Check that the cables to the door switch are intact and properly connected. It is seated with 2x cable lugs towards the door switch and one contact in the tray. 5. If the problem persists, the door switch is probably defective and needs to be replaced. 6. Detach the lock washer and press the door switch out from the front panel. 7. Assemble in the reverse sequence.
<p>The display shows an alarm/error code</p>	<p>This should normally never happen, but if an alarm or error code appears, first try to reset the alarm by holding down the START/STOP button for 5 sec.</p> <p>If the problem persists, use the list of error codes on page 22 to try to locate the error. Try to deal with the error indicated, but if the error persists, the whole unit (heat pump box) must be replaced.</p>
<p>Drying takes a long time</p>	<ol style="list-style-type: none"> 1. Clean the cleaning filter (this should preferably be done after each drying). 2. Check that the water tank is empty. 3. Check that the correct programme has been selected for the type of washing. 4. Check that the washing is not very wet (poorly spun). 5. Check that too much washing has not been hung up.
<p>The washing does not become dry</p>	<ol style="list-style-type: none"> 1. Check that the correct programme has been selected for the type of washing. 2. Check that too much washing has not been hung up. 3. Adjust the parameters 2072 and 2071 as described in the section on parameter adjustment.
<p>The sealing strip does not close tightly, the door is ajar</p>	<ol style="list-style-type: none"> 1. Check that the cabinet is level. Check with a spirit level, adjust with the adjustable feet if necessary. 2. Check that the cleaning filter and its holder are correctly fitted. The holder should be pressed down towards the heat pump unit beneath and locked with the rotatable locking angles to seal properly.

**NOTE: Opening
Float**

*Water tank with lid
removed*

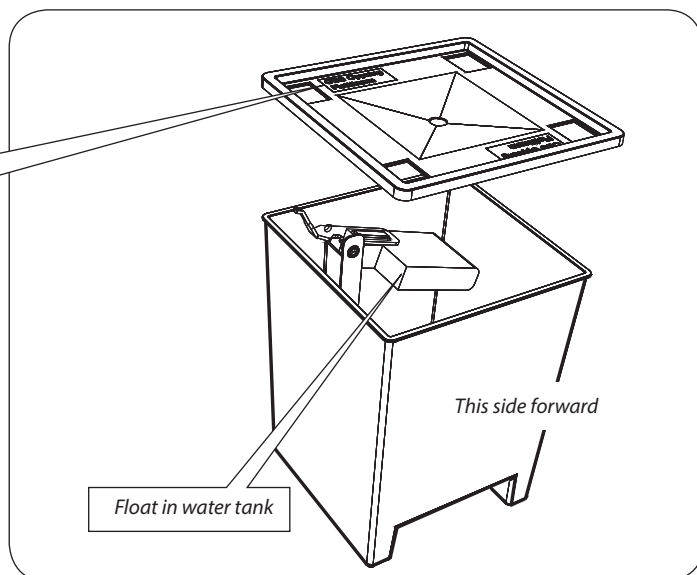

*Grille over cover after
shoe rack and lint filter
have been removed*

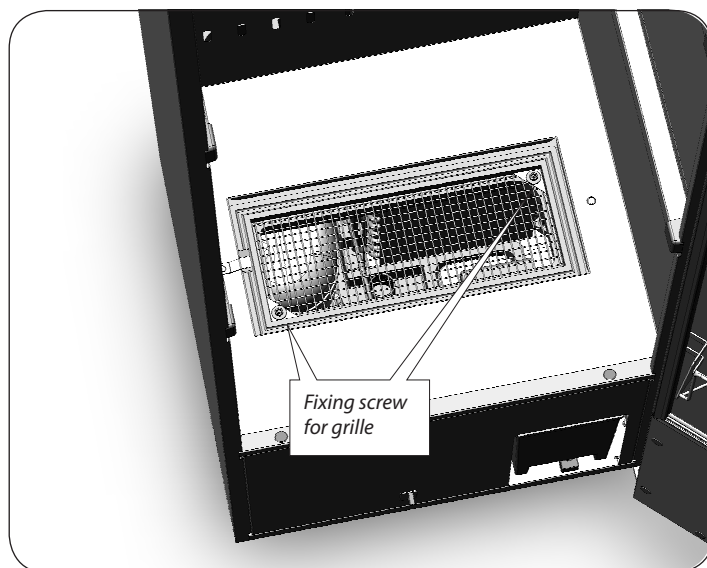

*Styrofoam protection and
fixing plate*

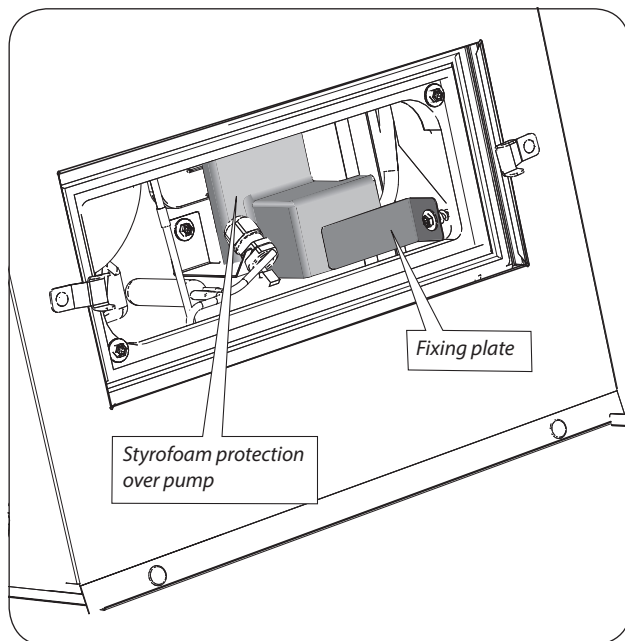

*The Styrofoam protection
and fixing plate have been
removed here*

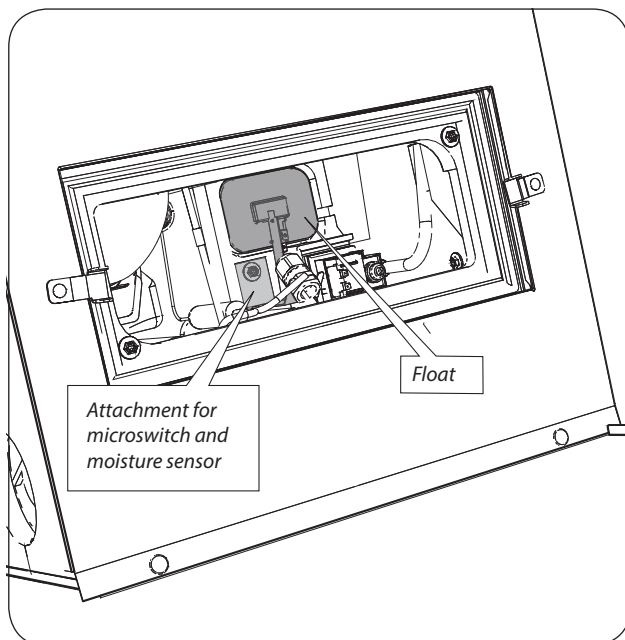

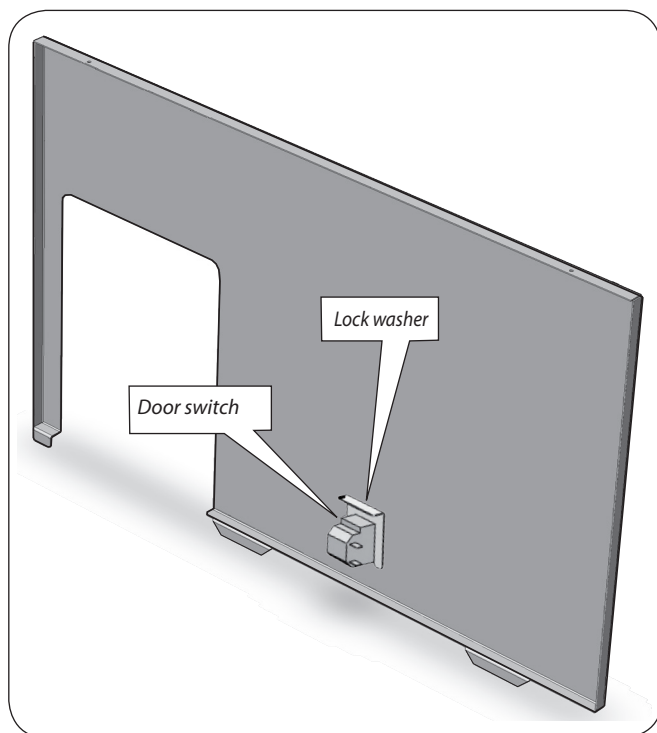

Front panel with door switch

11 Error code list

Describes relevant error codes for this product

<i>No.</i>	<i>Name</i>	<i>Description</i>
<i>ERR 03</i>	Error in moisture sensor	Sensor is outside its range of values
<i>ERR 04</i>	Max time process	Max time for drying process exceeded (preset value 180 min can be changed with parameter P 2073).
<i>ERR 06</i>	Check water pump	Water level in tray too high, has activated switch at float.
<i>ERR 12</i>	Timeout communication	Communication between user interface and electronics has been temporarily interrupted.

To reset the alarm, the **START/STOP** button should be held down for 5 sec.

